

STAFFORD BOROUGH COUNCIL

ROAD TRAFFIC REGULATION ACT 1984 TRAFFIC MANAGEMENT ACT 2004

THE BOROUGH OF STAFFORD (VARIOUS CAR PARKS, STONE) STONE OFF-STREET PARKING ORDER 2020 (VARIATION 2024)

The Council of the Borough of Stafford (hereinafter referred to as “the Council”) in exercise of its powers under Sections 35, 124(1)(d), and Part IV of Schedule 9 of the Road Traffic Regulation Act 1984 (hereinafter referred to as “the 1984 Act”), and under Part 6 of the Traffic Management Act 2004 (“the 2004 Act”), and of all other enabling powers, hereby amends the Traffic Regulation Order listed below, in accordance with Section 21 and Schedule 4 of the Local Authorities’ Traffic Orders (Procedure) (England and Wales).

1. This Order shall come into operation on the **1st day of July 2024**, and may be cited as the Borough of Stafford (Various Car Parks, Stone) Stone Off-Street Parking Order 2020 (Variation 2024), and shall be included within the Borough of Stafford (Various Car Parks, Stone) Stone Off-Street Parking Order 2020, which may together be cited as the Borough of Stafford (Various Car Parks, Stone) Stone Off-Street Parking Order 2020 (as amended).
2.
 - (i) The expression “Principal Order” means the Borough of Stafford (Various Car Parks, Stone) Stone Off-Street Parking Order 2020 which came into operation on the 16th day of March 2020.
 - (ii) Any document referring to the Principal Order shall be construed as referring to the Principal Order as varied by this Order.
3. The Principal Order shall be varied as follows:-
 - (i) The plan contained within the Principal Order showing the parking place (insofar as it relates to Stone Leisure Centre only) shall be replaced with the plan showing the area marked in red which accompanies this Order.
 - (ii) The following restrictions are inserted into the Principal Order as Clause 35.
 35. When parking, the owner of a vehicle will be contravening the provisions of this Order and may be subject to a Penalty Charge if one or more of the following occurs:
 - a. Failure to have a valid parking ticket or parking permit.
 - b. Vehicle parked in a marked disabled parking bay without displaying a Disabled Person’s Badge.

- c. Vehicle parked in a marked electric vehicle charging bay without charging the vehicle.
 - d. Vehicle parked not wholly within a marked parking bay.
 - e. Vehicle left in a parking place which exceeds the hours permitted as specified in column 6 of the Schedule to the Principal Order.
 - f. Vehicle left parked along the Stone Leisure Centre access road, as indicated by red markings on the plan accompanying this Order.
4. Nothing in this Order shall affect the Principal Order in its operation in relation to offences committed before the commencement of this Order.

THE COMMON SEAL OF THE
COUNCIL OF THE BOROUGH OF
STAFFORD was hereunto affixed
this 6th day of June 2024
in the presence of:-

Collette Lamb

Authorised Signatory

1:1250

Stafford Borough Council
Stone Leisure Centre Car Park

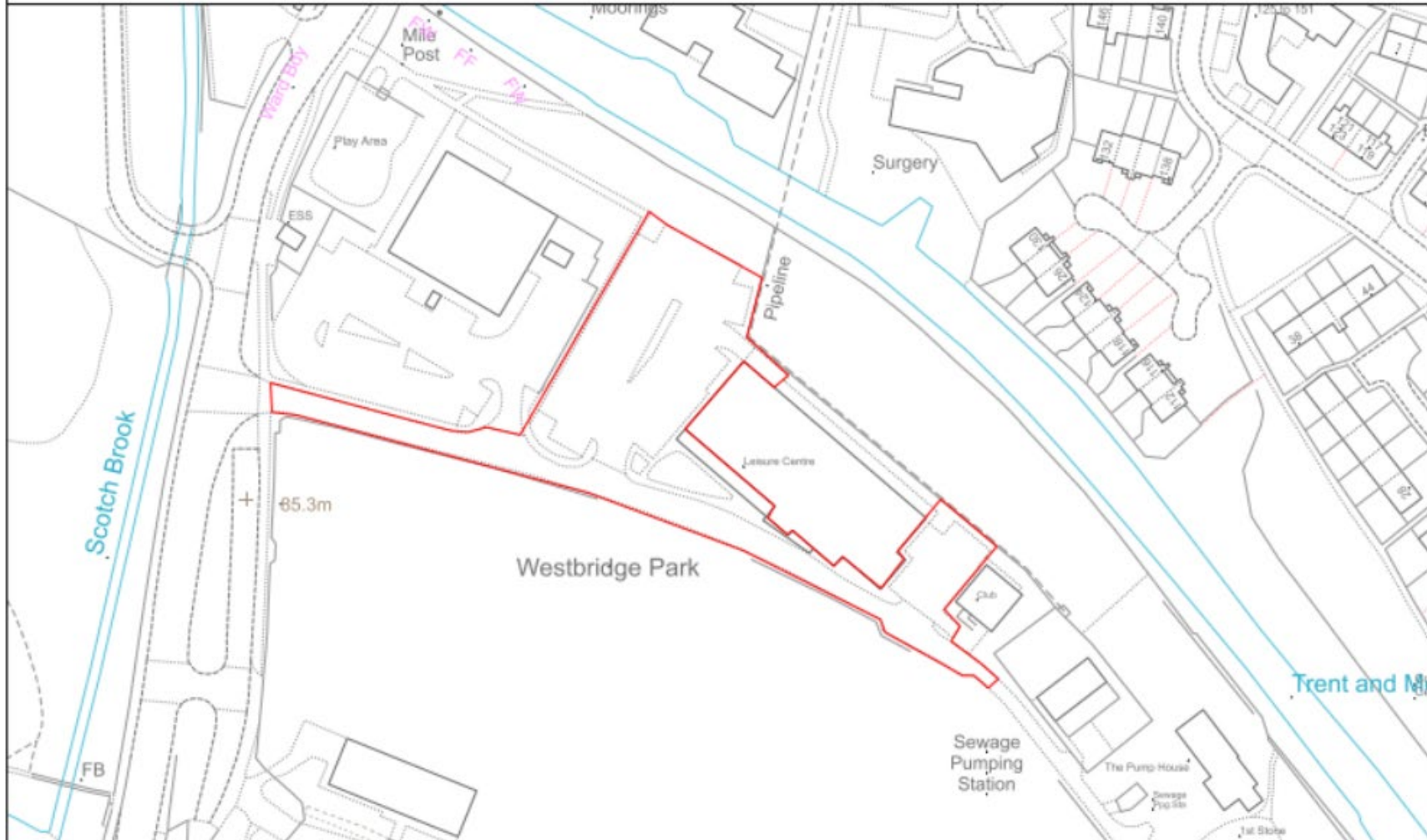

© Crown copyright and database rights [2024] Ordnance Survey [AC0000816792]
You are not permitted to copy, sub-license, distribute or sell any of this data to third parties in any form.

Date Created:
07-02-2024

