

Dear Members

Licensing Sub Committee

A meeting of the Licensing Sub Committee will be held on **Wednesday 5 November at 10.00am** in the **Craddock Room, Civic Centre, Riverside, Stafford** to deal with the business as set out on the agenda.

Please note that this meeting will be recorded.

Members are reminded that contact officers are shown in each report and members are welcome to raise questions etc in advance of the meeting with the appropriate officer.



Head of Law and Governance

LICENSING SUB COMMITTEE

5 NOVEMBER 2025

Chair - Councillor A M Loughran

AGENDA

- 1 Apologies
- 2 Officer's Reports

Page Nos

ITEM NO 2(a)	Application for a Premises Licence: Tigerbite, 7-8 Mill Street, Stafford, ST16 2AJ	3 - 35
--------------	---	--------

REPORT OF THE LICENSING MANAGER

Membership

Chair - Councillor A M Loughran

A G Cooper	J A Nixon
A P Edgeller	L Nixon
P A Leason	J P Read
A M Loughran	J T Rose
B McKeown	J Thorley

(The 3 Members to form the Sub Committee will be appointed from the above)

Agenda Item 2(a)

Committee:	Licensing Sub Committee
Date of Meeting:	5 November 2025
Report of:	Licensing Manager
Contact Officer:	Scot Kearney/Leo Parkes
Telephone Number:	01785 619361
Ward Interest:	Forebridge

Application for a Premises Licence: Tigerbite, 7-8 Mill Street, Stafford, ST16 2AJ

Purpose of Report

To consider an Application for a Premises Licence for Tigerbite, 7-8 Mill Street, Stafford, ST16 2AJ.

1 Detail

- 1.1 On 12 September 2025 the Council received an application for a Premises Licence for Tigerbite, 7-8 Mill Street, Stafford, ST16 2AJ.
- 1.2 The application is for a Late-Night Refreshment Licence to operate from 23:00hrs – 03:00hrs seven days a week.
- 1.3 The application was made by Sobeya Akhtar on behalf of the proposed Premises Licence Holder, Stafford Fastfood Ltd.
- 1.4 There have been no objections from any of the Responsible Authorities.
- 1.5 There have been two relevant representations from local residents and businesses who are concerned about potential nuisance from cars and delivery vehicles.
- 1.6 The objections relate to one of the four of the Licensing Objectives: the Prevention of Public Nuisance.

1.7 As part of the process, it is noted that Stafford Borough Council issued planning permission (with conditions) for development of the site dated 13 December 2023. With regards to the operating hours stated on that authorisation, the following conditions may be deemed relevant at this time:

- The opening hours of the restaurant and takeaway shall be between the hours of 11:00am and 03:00am as stated on application forms.
- All deliveries to the premises shall only take place between the hours of 8:00am and 18:00pm on any day
- A delivery only service shall operate from 23:00hours on any day

A copy of the planning development document issued by Stafford Borough Council is attached to this report at Appendix 5.

1.8 The documents relating to the application including the application for the Premises Licence and the two representations are attached as Appendices as follows:

Appendix 1 - Premises Licence Application

Appendix 2 - Proposed Floor Plan

Appendix 3 - Representation from Mr Anthony Rogers

Appendix 4 - Representation from Mr A R Parker

Appendix 5 - Permission For Development of Tigerbite, 7-8 Mill Street, Stafford, ST16 2AJ

2 Previous Consideration

2.1 The same site previously held a premises licence under the premises licence holder Tiger Bite ST16 Ltd, with the following licensable activities and hours:

Provision of Late Night Refreshment (indoors)

Monday to Sunday - from 23:00hrs to 03:00hrs

Opening Hours

Monday to Sunday - from 12:00hrs to 03:00hrs

2.2 The previous Premises Licence was also subject to licence conditions as follows:

1. A noise management plan shall be submitted in writing to the Licensing Authority for the written approval of the Licensing Authority. The noise management plan shall cover all activities at the premises, including the use of the smoking area and ingress and egress from the premises. The controls and requirements of the noise management plan including any conditions attached to the written approval issued by the Licensing Authority shall be complied with at all times. This plan shall be subject to regular review and any changes necessary shall be submitted in writing to the Licensing Authority.
2. All staff are to be made aware of the license conditions, particularly the noise management plan.
3. A complaints procedure is to be put in place to deal with any complaints relating to the licensable activities.
4. All doors and windows to the premises are to be kept closed at all times, save for access and egress.
5. Clear and legible notices must be prominently displayed at all exits requesting the public to respect the needs of local residents and to leave the premises and area quietly.
6. No customer shall be permitted to enter the premises after 22:45.
7. Customers and staff shall not enter or leave the premises after 23:00 by the front door on Mill Street, except in the event of an emergency.
8. The premises licence holder must instruct delivery riders and drivers not to cause a noise nuisance when making deliveries or whilst waiting outside the premises for collections.
9. Delivery vehicles shall switch off their engines whilst stationary and collecting orders for delivery. Delivery vehicle horns shall not be used at any time, except in accordance with the Highway Code.
10. Customers must be instructed when placing the order that they will not be able to collect the order from the vehicle. All deliveries will only be made directly to the property address and customers will not be permitted to take orders from the vehicle.
11. Noise from any ventilation, refrigeration or air conditioning plant or equipment shall not cause nuisance to the occupants of any properties in the vicinity.

Recommendation:

- (a) The Rating Level of any noise from any fixed plant shall not exceed the background noise level by more than 5dB at the nearest noise sensitive property as determined by BS 4142: 2014+A1:2019 Methods for Rating and Assessing Industrial and Commercial Sound’.
 - (b) Anti vibration mounts should be used to isolate plant from fixed structures and a flexible connector used to connect the flue to the fan if there is a potential to transmit vibration to any noise sensitive property. Any systems will also need regular maintenance to reduce mechanical noise. Guidance on the above can be gained from the ‘Control of Odour and Noise from Commercial Kitchen Exhaust Systems’ document published by EMAQ+.
- 12. The premises licence holder shall ensure that measures are put in place to remove litter or waste arising from customers and to prevent such litter from accumulating in the immediate vicinity of the premises or neighbouring premises.
- 13. The lighting at the front of the premises must be turned off at 23:00 hours each day
- 14. Waste from the premises must only be emptied to external waste receptacles between 08:00 and 23:00 hours.
- 2.3 This premises licence lapsed on 1 April 2025 due to the dissolution of the premises licence-holding company, Tiger Bite ST16 Ltd.

3 Human Rights Act 1998 Implications

- 3.1 Article 6 of the Act provides that where a person’s civil rights and obligations are being determined, the person is entitled to a “fair trial”. The Council complies with Article 6 in that it gives the person the opportunity to state their case, will make a decision within a reasonable period of time and will give reasons for its decision.
- 3.2 The Article also provides for the issue to be determined by an independent tribunal. The right of appeal to the Magistrates’ Court against the Council’s decision fulfils this.
- 3.3 The Council observes the rules of natural justice, and its procedures are consistent with Article 6 of the Human Rights Act 1998.

4 Recommendation

- 4.1 That the Licensing Sub-committee considers the application for the grant of a Premises Licence and considers whether to grant as applied for, or whether to add or amend conditions as deemed appropriate, taking into consideration the representations made before you.

5 Background Papers

File available in Licensing Section



Stafford
Application for a premises licence
Licensing Act 2003

For help contact
ehlicensing@staffordbc.gov.uk
 Telephone: 01785 619745

* required information

Section 1 of 21

You can save the form at any time and resume it later. You do not need to be logged in when you resume.

System reference Not Currently In Use

This is the unique reference for this application generated by the system.

Your reference Tiger Bite ST6 LTD

You can put what you want here to help you track applications if you make lots of them. It is passed to the authority.

Are you an agent acting on behalf of the applicant?

☐ Yes ☒ No

Put "no" if you are applying on your own behalf or on behalf of a business you own or work for.

Applicant Details

* First name Sobeya

* Family name Akhtar

* E-mail info@tigerbite.co.uk

Main telephone number 03333231707

Include country code.

Other telephone number

× Indicate here if you would prefer not to be contacted by telephone

Are you:

☒ Applying as a business or organisation, including as a sole trader

☐ Applying as an individual

A sole trader is a business owned by one person without any special legal structure. Applying as an individual means you are applying so you can be employed, or for some other personal reason, such as following a hobby.

Applicant Business

Is your business registered in the UK with Companies House? ☒ Yes ☐ No

Note: completing the Applicant Business section is optional in this form.

Registration number 16982786

Business name Stafford Fastfood Ltd

If your business is registered, use its registered name.

VAT number -

Put "none" if you are not registered for VAT.

Legal status Private Limited Company

Continued from previous page...

Your position in the business Director

Home country United Kingdom

The country where the headquarters of your business is located.

Registered Address

Address registered with Companies House.

Building number or name 7-8

Street Mill Street

District

City or town Stafford

County or administrative area Staffordshire

Postcode ST16 2AJ

Country United Kingdom

Section 2 of 21

PREMISES DETAILS

I/we, as named in section 1, apply for a premises licence under section 17 of the Licensing Act 2003 for the premises described in section 2 below (the premises) and I/we are making this application to you as the relevant licensing authority in accordance with section 12 of the Licensing Act 2003.

Premises Address

Are you able to provide a postal address, OS map reference or description of the premises?

☒ Address ☐ OS map reference ☐ Description

Postal Address Of Premises

Building number or name 7-8

Street Mill Street

District

City or town Stafford

County or administrative area

Postcode ST16 2AJ

Country United Kingdom

Further Details

Telephone number 03333231707

Non-domestic rateable
value of premises (£) 22,250

Section 3 of 21

APPLICATION DETAILS

In what capacity are you applying for the premises licence?

An individual or individuals

× A limited company / limited liability partnership

A partnership (other than limited liability)

An unincorporated association

Other (for example a statutory corporation)

A recognised club

A charity

The proprietor of an educational establishment

A health service body

A person who is registered under part 2 of the Care Standards Act 2000 (c14) in respect of an independent hospital in Wales

A person who is registered under Chapter 2 of Part 1 of the Health and Social Care Act 2008 in respect of the carrying on of a regulated activity (within the meaning of that Part) in an independent hospital in England

The chief officer of police of a police force in England and Wales

Confirm The Following

× I am carrying on or proposing to carry on a business which involves the use of the premises for licensable activities

I am making the application pursuant to a statutory function

I am making the application pursuant to a function discharged by virtue of Her Majesty's prerogative

Section 4 of 21

NON INDIVIDUAL APPLICANTS

Provide name and registered address of applicant in full. Where appropriate give any registered number. In the case of a partnership or other joint venture (other than a body corporate), give the name and address of each party concerned.

Non Individual Applicant's Name

Name Stafford Fastfood Ltd

Details

Registered number (where applicable) 16082786

Description of applicant (for example partnership, company, unincorporated association etc)

Continued from previous page...

Stafford Fastfood Ltd

Address

Building number or name 7-8

Street Mill Street

District

City or town Stafford

County or administrative area Staffordshire

Postcode ST16 2AJ

Country United Kingdom

Contact Details

E-mail info@tigerbite.co.uk

Telephone number

Other telephone number

* Date of birth

dd / mm / yyyy

* Nationality British

[Documents that demonstrate entitlement to work in the UK](#)

Add another applicant

Section 5 of 21

OPERATING SCHEDULE

When do you want the premises licence to start? 07 / 09 / 2025

dd mm yyyy

If you wish the licence to be valid only for a limited period, when do you want it to end

dd / mm / yyyy

Provide a general description of the premises

For example the type of premises, its general situation and layout and any other information which could be relevant to the licensing objectives. Where your application includes off-supplies of alcohol and you intend to provide a place for consumption of these off- supplies you must include a description of where the place will be and its proximity to the premises.

We will be providing fast food and soft drinks to the local area

Continued from previous page...

If 5,000 or more people are expected to attend the premises at any one time, state the number expected to attend

Section 6 of 21

PROVISION OF PLAYS

[See guidance on regulated entertainment](#)

Will you be providing plays?

☐ Yes ☒ No

Section 7 of 21

PROVISION OF FILMS

[See guidance on regulated entertainment](#)

Will you be providing films?

☐ Yes ☒ No

Section 8 of 21

PROVISION OF INDOOR SPORTING EVENTS

[See guidance on regulated entertainment](#)

Will you be providing indoor sporting events?

☐ Yes ☒ No

Section 9 of 21

PROVISION OF BOXING OR WRESTLING ENTERTAINMENTS

[See guidance on regulated entertainment](#)

Will you be providing boxing or wrestling entertainments?

☐ Yes ☒ No

Section 10 of 21

PROVISION OF LIVE MUSIC

[See guidance on regulated entertainment](#)

Will you be providing live music?

☐ Yes ☒ No

Section 11 of 21

PROVISION OF RECORDED MUSIC

[See guidance on regulated entertainment](#)

Will you be providing recorded music?

☐ Yes ☒ No

Section 12 of 21

PROVISION OF PERFORMANCES OF DANCE

[See guidance on regulated entertainment](#)

Will you be providing performances of dance?

Continued from previous page...

Section 13 of 21

PROVISION OF ANYTHING OF A SIMILAR DESCRIPTION TO LIVE MUSIC, RECORDED MUSIC OR PERFORMANCES OF DANCE

[See guidance on regulated entertainment](#)

Will you be providing anything similar to live music, recorded music or performances of dance?

☐ Yes ☒ No

Section 14 of 21

LATE NIGHT REFRESHMENT

Will you be providing late night refreshment?

☒ Yes ☐ No

Standard Days And Timings

MONDAY

Start 23:00 End 03:00
Start End

Give timings in 24 hour clock.
(e.g., 16:00) and only give details for the days
of the week when you intend the premises
to be used for the activity.

TUESDAY

Start 23:00 End 03:00
Start End

WEDNESDAY

Start 23:00 End 03:00
Start End

THURSDAY

Start 23:00 End 03:00
Start End

FRIDAY

Start 23:00 End 03:00
Start End

SATURDAY

Start 23:00 End 03:00
Start End

SUNDAY

Start 23:00 End 03:00
Start End

Continued from previous page...

Will the provision of late night refreshment take place indoors or outdoors or both?

- ☒ Indoors ☐ Outdoors ☐ Both

Where taking place in a building or other structure tick as appropriate. Indoors may include a tent.

State type of activity to be authorised, if not already stated, and give relevant further details, for example (but not exclusively) whether or not music will be amplified or unamplified.

We will be providing fast food and soft drinks to the local area

State any seasonal variations

For example (but not exclusively) where the activity will occur on additional days during the summer months.

None

Non-standard timings. Where the premises will be used for the supply of late night refreshments at different times from those listed in the column on the left, list below

For example (but not exclusively), where you wish the activity to go on longer on a particular day e.g. Christmas Eve.

None

Section 15 of 21

SUPPLY OF ALCOHOL

Will you be selling or supplying alcohol?

- ☐ Yes ☒ No

PROPOSED DESIGNATED PREMISES SUPERVISOR CONSENT

How will the consent form of the proposed designated premises supervisor be supplied to the authority?

- ☒ Electronically, by the proposed designated premises supervisor
☐ As an attachment to this application

Reference number for consent form (if known)

If the consent form is already submitted, ask the proposed designated premises supervisor for its 'system reference' or 'your reference'.

Section 16 of 21

ADULT ENTERTAINMENT

Continued from previous page...

Highlight any adult entertainment or services, activities, or other entertainment or matters ancillary to the use of the premises that may give rise to concern in respect of children

Give information about anything intended to occur at the premises or ancillary to the use of the premises which may give rise to concern in respect of children, regardless of whether you intend children to have access to the premises, for example (but not exclusively) nudity or semi-nudity, films for restricted age groups etc gambling machines etc.

None

Section 17 of 21

HOURS PREMISES ARE OPEN TO THE PUBLIC

Standard Days And Timings

MONDAY

Start 12:00

End 03:00

Start

End

Give timings in 24 hour clock.
(e.g., 16:00) and only give details for the days
of the week when you intend the premises
to be used for the activity.

TUESDAY

Start 12:00

End 03:00

Start

End

WEDNESDAY

Start 12:00

End 03:00

Start

End

THURSDAY

Start 12:00

End 03:00

Start

End

FRIDAY

Start 12:00

End 03:00

Start

End

SATURDAY

Start 12:00

End 03:00

Start

End

SUNDAY

Start 12:00

End 03:00

Start

End

State any seasonal variations

For example (but not exclusively) where the activity will occur on additional days during the summer months.

Continued from previous page...

None

Non standard timings. Where you intend to use the premises to be open to the members and guests at different times from those listed in the column on the left, list below

For example (but not exclusively), where you wish the activity to go on longer on a particular day e.g. Christmas Eve.

None

Section 18 of 21

LICENSING OBJECTIVES

Describe the steps you intend to take to promote the four licensing objectives:

a) General – all four licensing objectives (b,c,d,e)

List here steps you will take to promote all four licensing objectives together.

Installation of internal and external CCTV system to monitor activity. This will be recorded 24 hours a day and be kept for 28 days.

Safe area for customers to place and collect orders separate from cooking areas

Promote our online ordering business model to deliver to customers directly without the need to attend the premises (this will lower the possible footfall inside the takeaway)

Seating area inside to be closed to the public from midnight each night.

The Store, albeit with a new Director, is still predominantly managed by the same Team, therefore adhering to our previously agreed conditions won't be an issue. Any new members of the Team will be suitably trained on the adopted conditions imposed

The Store intends to carry on with the previous agreements and conditions in place- last dine in orders via front access at 22.45. Lights shall be dimmed and the front door locked at 23:00 to reduce the appearance of being open, and therefore reducing the amount of foot traffic. Any in store music will be turned off at 23:00

All of Tigerbites delivery drivers are directly linked to us, and not those of third party aggregators such as Just Eat, Uber Eats etc. They need to abide by our internal policies, and can be managed on a daily basis by our Management Team. Any failures to adhere to our Policies can result in disciplinary action or dismissal where appropriate

b) The prevention of crime and disorder

Internal and external CCTV to be installed to monitor activities of all stakeholders. This will be recorded 24 hours a day and be kept for 28 days.

Competent person trained in the use of CCTV at premises while open to the public.

The reporting of any unlawful behavior or activities.

Current business model promotes the delivery of takeaway items therefore we would expect low levels of walk in customers and more Online orders for delivery.

If required by local authority SIA security can be provided where deemed necessary. Necessary paperwork can be filed.

Incident register of all ejections from the premises can be maintained and provided.

Clear CCTV signage displayed to notify customers. Signage also to advise customers to be respectful of noise levels when leaving the property.

Seating area inside to be closed to the public from midnight each night.

c) Public safety

CCTV internal and external to monitor activities.

Continued from previous page...

Fire safety equipment in case of fire.

Safe environment for walk in customers segmented from any cooking zones.

Current business model promotes the delivery of takeaway items therefore we would expect low levels of walk in customers and more online orders for delivery.

No alcohol to be served at any point.

Seating area inside to be closed to the public from midnight each night.

d) The prevention of public nuisance

No playing of loud music.

Delivery drivers to be respectful to the local area relating to noise .

Internal and external CCTV to be installed to monitor activities of all stakeholders

The reporting of any unlawful behavior or activities.

Current business model promotes the delivery of takeaway items therefore we would expect low levels of walk in customers and more online orders for delivery.

This is an extension of a current business with no previous history of public nuisance.

Incident register of all ejections from the premises can be maintained and provided.

Clear CCTV signage displayed to notify customers. Signage also to advise customers to be respectful of noise levels when leaving the property.

Seating area inside to be closed to the public from midnight each night.

No further operational changes have been made, so these findings remain valid.

Noise Assessment Report from October 2023 is attached. Despite it being historic, there will have been very few or no changes to the environmental surroundings, so I believe it should still remain valid.

Drivers shall turn their radio/music off upon entering the rear car park to reduce any detrimental noise impact. Drivers shall not leave their engines idle. Drivers cannot congregate and have conversation which may have a negative impact

All deliveries shall take place from the rear of the property where the noise threshold is higher. This has been the case under previous Directorship for over a year, where the Store has received no complaints with regards to increased noise/anti social occurrences

e) The protection of children from harm

Remain within employment law on any employment positions or work experience comply with working regulations.

Section 19 of 21

NOTES ON DEMONSTRATING ENTITLEMENT TO WORK IN THE UK

Continued from previous page...

Entitlement to work/immigration status for individual applicants and applications from partnerships which are not limited liability partnerships:

A licence may not be held by an individual or an individual in a partnership who is resident in the UK who:

- does not have the right to live and work in the UK; or
- is subject to a condition preventing him or her from doing work relating to the carrying on of a licensable activity.

Any premises licence issued in respect of an application made on or after 6 April 2017 will become invalid if the holder ceases to be entitled to work in the UK.

Applicants must demonstrate that they have an entitlement to work in the UK and are not subject to a condition preventing them from doing work relating to the carrying on of a licensable activity. They do this in one of two ways: 1) by providing with this application copies or scanned copies of the documents listed below (which do not need to be certified), or 2) by providing their 'share code' to enable the licensing authority to carry out a check using the Home Office online right to work checking service (see below).

Documents which demonstrate entitlement to work in the UK

- An expired or current passport showing the holder, or a person named in the passport as the child of the holder, is a British citizen or a citizen of the UK and Colonies having the right of abode in the UK [please see note below about which sections of the passport to copy].
- An expired or current passport or national identity card showing the holder, or a person named in the passport as the child of the holder, is a national of a European Economic Area country or Switzerland.
- A Registration Certificate or document certifying permanent residence issued by the Home Office to a national of a European Economic Area country or Switzerland.
- A Permanent Residence Card issued by the Home Office to the family member of a national of a European Economic Area country or Switzerland.
- A **current** Biometric Immigration Document (Biometric Residence Permit) issued by the Home Office to the holder indicating that the person named is allowed to stay indefinitely in the UK, or has no time limit on their stay in the UK.
- A **current** passport endorsed to show that the holder is exempt from immigration control, is allowed to stay indefinitely in the UK, has the right of abode in the UK, or has no time limit on their stay in the UK.
- A **current** Immigration Status Document issued by the Home Office to the holder with an endorsement indicating that the named person is allowed to stay indefinitely in the UK or has no time limit on their stay in the UK, **when produced in combination with** an official document giving the person's permanent National Insurance number and their name issued by a Government agency or a previous employer.
- A birth or adoption certificate issued in the UK, **when produced in combination with** an official document giving the person's permanent National Insurance number and their name issued by a Government agency or a previous employer.
- A birth or adoption certificate issued in the Channel Islands, the Isle of Man or Ireland **when produced in combination with** an official document giving the person's permanent National Insurance number and their name issued by a Government agency or a previous employer.
- A certificate of registration or naturalisation as a British citizen, **when produced in combination with** an official document giving the person's permanent National Insurance number and their name issued by a Government agency or a previous employer.

Continued from previous page...

- A **current** passport endorsed to show that the holder is allowed to stay in the UK and is currently allowed to work and is not subject to a condition preventing the holder from doing work relating to the carrying on of a licensable activity.
- A **current** Biometric Immigration Document (Biometric Residence Permit) issued by the Home Office to the holder which indicates that the named person can currently stay in the UK and is allowed to work relation to the carrying on of a licensable activity.
- A **current** Residence Card issued by the Home Office to a person who is not a national of a European Economic Area state or Switzerland but who is a family member of such a national or who has derivative rights or residence.
- A **current** Immigration Status Document containing a photograph issued by the Home Office to the holder with an endorsement indicating that the named person may stay in the UK, and is allowed to work and is not subject to a condition preventing the holder from doing work relating to the carrying on of a licensable activity **when produced in combination with** an official document giving the person's permanent National Insurance number and their name issued by a Government agency or a previous employer.
- A Certificate of Application, **less than 6 months old**, issued by the Home Office under regulation 18(3) or 20(2) of the Immigration (European Economic Area) Regulations 2016, to a person who is not a national of a European Economic Area state or Switzerland but who is a family member of such a national or who has derivative rights of residence.
- Reasonable evidence that the person has an outstanding application to vary their permission to be in the UK with the Home Office such as the Home Office acknowledgement letter or proof of postage evidence, or reasonable evidence that the person has an appeal or administrative review pending on an immigration decision, such as an appeal or administrative review reference number.
- Reasonable evidence that a person who is not a national of a European Economic Area state or Switzerland but who is a family member of such a national or who has derivative rights of residence in exercising treaty rights in the UK including:-
 - evidence of the applicant's own identity – such as a passport,
 - evidence of their relationship with the European Economic Area family member – e.g. a marriage certificate, civil partnership certificate or birth certificate, and
 - evidence that the European Economic Area national has a right of permanent residence in the UK or is one of the following if they have been in the UK for more than 3 months:
 - (i) working e.g. employment contract, wage slips, letter from the employer,
 - (ii) self-employed e.g. contracts, invoices, or audited accounts with a bank,
 - (iii) studying e.g. letter from the school, college or university and evidence of sufficient funds; or
 - (iv) self-sufficient e.g. bank statements.

Family members of European Economic Area nationals who are studying or financially independent must also provide evidence that the European Economic Area national and any family members hold comprehensive sickness insurance in the UK. This can include a private medical insurance policy, an EHIC card or an S1, S2 or S3 form.

Original documents must not be sent to licensing authorities. If the document copied is a passport, a copy of the following pages should be provided:-

- (i) any page containing the holder's personal details including nationality;
- (ii) any page containing the holder's photograph;
- (iii) any page containing the holder's signature;
- (iv) any page containing the date of expiry; and
- (v) any page containing information indicating the holder has permission to enter or remain in the UK and is permitted to work.

Continued from previous page...

If the document is not a passport, a copy of the whole document should be provided.

Your right to work will be checked as part of your licensing application and this could involve us checking your immigration status with the Home Office. We may otherwise share information with the Home Office. Your licence application will not be determined until you have complied with this guidance.

Home Office online right to work checking service

As an alternative to providing a copy of the documents listed above, applicants may demonstrate their right to work by allowing the licensing authority to carry out a check with the Home Office online right to work checking service.

To demonstrate their right to work via the Home Office online right to work checking service, applicants should include in this application their 9-digit share code (provided to them upon accessing the service at <https://www.gov.uk/prove-right-to-work>) which, along with the applicant's date of birth (provided within this application), will allow the licensing authority to carry out the check.

In order to establish the applicant's right to work, the check will need to indicate that the applicant is allowed to work in the United Kingdom and is not subject to a condition preventing them from doing work relating to the carrying on of a licensable activity.

An online check will not be possible in all circumstances because not all applicants will have an immigration status that can be checked online. The Home Office online right to work checking service sets out what information and/or documentation applicants will need in order to access the service. Applicants who are unable to obtain a share code from the service should submit copy documents as set out above.

Section 20 of 21

NOTES ON REGULATED ENTERTAINMENT

Continued from previous page...

In terms of specific **regulated entertainments** please note that:

- Plays: no licence is required for performances between 08:00 and 23.00 on any day, provided that the audience does not exceed 500.
- Films: no licence is required for 'not-for-profit' film exhibition held in community premises between 08.00 and 23.00 on any day provided that the audience does not exceed 500 and the organiser (a) gets consent to the screening from a person who is responsible for the premises; and (b) ensures that each such screening abides by age classification ratings.
- Indoor sporting events: no licence is required for performances between 08.00 and 23.00 on any day, provided that the audience does not exceed 1000.
- Boxing or Wrestling Entertainment: no licence is required for a contest, exhibition or display of Greco-Roman wrestling, or freestyle wrestling between 08.00 and 23.00 on any day, provided that the audience does not exceed 1000. Combined fighting sports – defined as a contest, exhibition or display which combines boxing or wrestling with one or more martial arts – are licensable as a boxing or wrestling entertainment rather than an indoor sporting event.
- Live music: no licence permission is required for:
 - o a performance of unamplified live music between 08.00 and 23.00 on any day, on any premises.
 - o a performance of amplified live music between 08.00 and 23.00 on any day on premises authorised to sell alcohol for consumption on those premises, provided that the audience does not exceed 500.
 - o a performance of amplified live music between 08.00 and 23.00 on any day, in a workplace that is not licensed to sell alcohol on those premises, provided that the audience does not exceed 500.
 - o a performance of amplified live music between 08.00 and 23.00 on any day, in a church hall, village hall, community hall, or other similar community premises, that is not licensed by a premises licence to sell alcohol, provided that (a) the audience does not exceed 500, and (b) the organiser gets consent for the performance from a person who is responsible for the premises.
 - o a performance of amplified live music between 08.00 and 23.00 on any day, at the non-residential premises of (i) a local authority, or (ii) a school, or (iii) a hospital, provided that (a) the audience does not exceed 500, and (b) the organiser gets consent for the performance on the relevant premises from: (i) the local authority concerned, or (ii) the school or (iii) the health care provider for the hospital.
- Recorded Music: no licence permission is required for:
 - o any playing of recorded music between 08.00 and 23.00 on any day on premises authorised to sell alcohol for consumption on those premises, provided that the audience does not exceed 500.
 - o any playing of recorded music between 08.00 and 23.00 on any day, in a church hall, village hall, community hall, or other similar community premises, that is not licensed by a premises licence to sell alcohol, provided that (a) the audience does not exceed 500, and (b) the organiser gets consent for the performance from a person who is responsible for the premises.
 - o any playing of recorded music between 08.00 and 23.00 on any day, at the non-residential premises of (i) a local authority, or (ii) a school, or (iii) a hospital, provided that (a) the audience does not exceed 500, and (b) the organiser gets consent for the performance on the relevant premises from: (i) the local authority concerned, or (ii) the school proprietor or (iii) the health care provider for the hospital.

Continued from previous page...

- Dance: no licence is required for performances between 08.00 and 23.00 on any day, provided that the audience does not exceed 500. However, a performance which amounts to adult entertainment remains licensable.
- Cross activity exemptions: no licence is required between 08.00 and 23.00 on any day, with no limit on audience size for:
 - o any entertainment taking place on the premises of the local authority where the entertainment is provided by or on behalf of the local authority;
 - o any entertainment taking place on the hospital premises of the health care provider where the entertainment is provided by or on behalf of the health care provider;
 - o any entertainment taking place on the premises of the school where the entertainment is provided by or on behalf of the school proprietor; and
 - o any entertainment (excluding films and a boxing or wrestling entertainment) taking place at a travelling circus, provided that (a) it takes place within a moveable structure that accommodates the audience, and (b) that the travelling circus has not been located on the same site for more than 28 consecutive days.

Section 21 of 21

PAYMENT DETAILS

This fee must be paid to the authority. If you complete the application online, you must pay it by debit or credit card.

Premises Licence Fees are determined by the non domestic rateable value of the premises.

To find out a premises non domestic rateable value go to the Valuation Office Agency site at http://www.voa.gov.uk/business_rates/index.htm

Band A - No RV to £4300 £100.00

Band B - £4301 to £33000 £190.00

Band C - £33001 to £87000 £315.00

Band D - £87001 to £125000 £450.00*

Band E - £125001 and over £635.00*

*If the premises rateable value is in Bands D or E and the premises is primarily used for the consumption of alcohol on the premises then your are required to pay a higher fee

Band D - £87001 to £125000 £900.00

Band E - £125001 and over £1,905.00

There is an exemption from the payment of fees in relation to the provision of regulated entertainment at church halls, chapel halls or premises of a similar nature, village halls, parish or community halls, or other premises of a similar nature. The costs associated with these licences will be met by central Government. If, however, the licence also authorises the use of the premises for the supply of alcohol or the provision of late night refreshment, a fee will be required.

Schools and sixth form colleges are exempt from the fees associated with the authorisation of regulated entertainment where the entertainment is provided by and at the school or college and for the purposes of the school or college.

If you operate a large event you are subject to ADDITIONAL fees based upon the number in attendance at any one time

Capacity 5000-9999 £1,000.00

Capacity 10000 -14999 £2,000.00

Capacity 15000-19999 £4,000.00

Capacity 20000-29999 £8,000.00

Capacity 30000-39000 £16,000.00

Capacity 40000-49999 £24,000.00

Capacity 50000-59999 £32,000.00

Capacity 60000-69999 £40,000.00

Capacity 70000-79999 £48,000.00

Capacity 80000-89999 £56,000.00

Capacity 90000 and over £64,000.00

* Fee amount (£) 190.00

DECLARATION

Continued from previous page...

How we use your personal information The information that you have provided on this form will be used by Stafford Borough Council, who are the data controller, for the processing of your application and providing you with a licence. We will only share your information with/ or on The Public Register, The Home Office, other Government agencies, Council departments and Enforcement agencies and the National Fraud Initiative when necessary or where the law otherwise requires or allows us to do so. For further information, please see www.staffordbc.gov.uk/privacynotices

✕ Ticking this box indicates you have read and understood the above declaration

This section should be completed by the applicant, unless you answered "Yes" to the question "Are you an agent acting on behalf of the applicant?"

* Full name	Sobeya Akhtar
* Capacity	Director
* Date	08 / 09 / 2025 dd mm yyyy

Add another signatory

Once you're finished you need to do the following:

1. Save this form to your computer by clicking file/save as...
2. Go back to <https://www.gov.uk/apply-for-a-licence/premises-licence/stafford/apply-1> to upload this file and continue with your application.

Don't forget to make sure you have all your supporting documentation to hand.

IT IS AN OFFENCE LIABLE TO SUMMARY CONVICTION TO A FINE OF ANY AMOUNT UNDER SECTION 158 OF THE LICENSING ACT 2003, TO MAKE A FALSE STATEMENT IN OR IN CONNECTION WITH THIS APPLICATION

IT IS AN OFFENCE UNDER SECTION 24B OF THE IMMIGRATION ACT 1971 FOR A PERSON TO WORK WHEN THEY KNOW, OR HAVE REASONABLE CAUSE TO BELIEVE, THAT THEY ARE DISQUALIFIED FROM DOING SO BY REASON OF THEIR IMMIGRATION STATUS. THOSE WHO EMPLOY AN ADULT WITHOUT LEAVE OR WHO IS SUBJECT TO CONDITIONS AS TO EMPLOYMENT WILL BE LIABLE TO A CIVIL PENALTY UNDER SECTION 15 OF THE IMMIGRATION, ASYLUM AND NATIONALITY ACT 2006 AND PURSUANT TO SECTION 21 OF THE SAME ACT, WILL BE COMMITTING AN OFFENCE WHERE THEY DO SO IN THE KNOWLEDGE, OR WITH REASONABLE CAUSE TO BELIEVE, THAT THE EMPLOYEE IS DISQUALIFIED

OFFICE USE ONLY	
Applicant reference number	Tiger Bite ST6 LTD
Fee paid	
Payment provider reference	
ELMS Payment Reference	
Payment status	
Payment authorisation code	
Payment authorisation date	
Date and time submitted	
Approval deadline	
Error message	
Is Digitally signed	
1 2 3 4 5 6 7 8 9 10 11 12 13 14 15 16 17 18 19 20 21 Next >	

<u>TIGERBITE ST16 LTD NOISE MANAGEMENT PLAN</u>											
				Tigerbite Stafford, 7-8 Mill Street, Stafford, ST16 2AJ							
<u>SITE SUMMARY</u>				Ground floor, double fronted takeaway property, opening currently from 12:00 until 23:00, Monday to Saturday. Store currently operates 90% of its business as home delivery. With extended opening hours, this will rise to 95% +. Daily LNR licence granted until 03:00 based on a series of approved conditons. Offices above operating predominantly daytime. Music school operates until early evening.							
<u>KEY OBJECTIVES</u>				Minimise impact on local residents, particularly from a noise and public nuisance perspective. Need to satisfy local authority following a LNR licence hearing, which was granted based on a series of conditions. Suitably identify noise sources, levels and manage control thereof. Define a system to monitor noise, and communication with the public and relevant local authority.							
<u>LOCATION PLAN</u>				Ground floor within Mill Street, in close proximity to neighbouring shops and offices above. There are also four neighbouring residential properties nearby where any excess noise could have a detrimental effect. Front entrance of property borders onto a narrow street with low noise threshold. Rear of proprty abcks onto two car aprks which sits on a busy road inbetween the canal and bars, and is a high traffic exit route. As we don't intend to run any events other than our daily operation, there should be no sharp or prolonged activity of excess noise.							
<u>NOISE SOURCE INVENTORY</u>				Noise or distraction to local residents outside of the permitted 08:00-23:00 window will likely occur from the front door area bordering onto Mill Street, the rear area car park bordering onto Mill Bank bus and taxi route, and from our extraction system which runs externally at the rear of our property. Drivers would collect and leave via our rear entrance, so potential for elevated noise.							
<u>NOISE CONTROLS</u>				<p>To reduce noise outside of permitted times, external contractors, eg- waste collection and food deliveries- cannot access site until 08:00, and not after 18:00. Lights at front of shop which could attract customers outside of standard hours, to be switched off at 22:45 which would be last collection time for in store. Lights within front area of takeaway have been isolated, so these can also be switched off at 22:45 to reduce visibility to passers by, and therefore lower risk of public nuisance. No music presently in store. However, if introduced, this would be kept at a reasonable level throughout, and switched off at 22:45 in conjunction with walk in closure. 100% delivery service after 23:00, and only to fixed abodes. Drivers in the evening are from our internal driver team, so no reliance on Uber Eats/Just Eat drivers, meaning we can implement a code of conduct that forms part of their contract. This would include commitments regarding noise- any in car music must be turned off before entering car park on Mill Bank. Driver must approach quietly and cannot congregate, and remain in car until their pick up is ready, limiting the potential noise and disturbance. Any driver not following this is subject to review and potential consequence if deemed necessary. Extraction fans- currently waiting noise readings, but from professional opinion, these are lower than usual. Fans are fitted with a silencer to reduce noise output. Readings will be confirmed once given, and we can compare this to local authority for acceptable noise levels. Currently no walk in refrigeration which would require extrenal compressors. From speaking to local community, the noise generated by thre previous tenants was minimal at best, and generated no issues. We are currently running with less noise generating. All team must leave quietly via the rear door. Internal poster dplayed to all team and drivers asking for quiet upon exit in order to respect local neighbours.</p>							
<u>NOISE MONITORING</u>				Need to establish acceptable noise levels during LNR hours from local authority. Noise reports will be complied week beginning Monday 2nd October 2023. These will be completed by Stevn Mellor, from SBM Safety Solutions Ltd. He is a Member of the Institute of Acoustics. Calibration certificates can be provided for the follwoing equipment that will be used- SVAN 977 Class 1, SVAN 977A Class 1.							

[illegible]

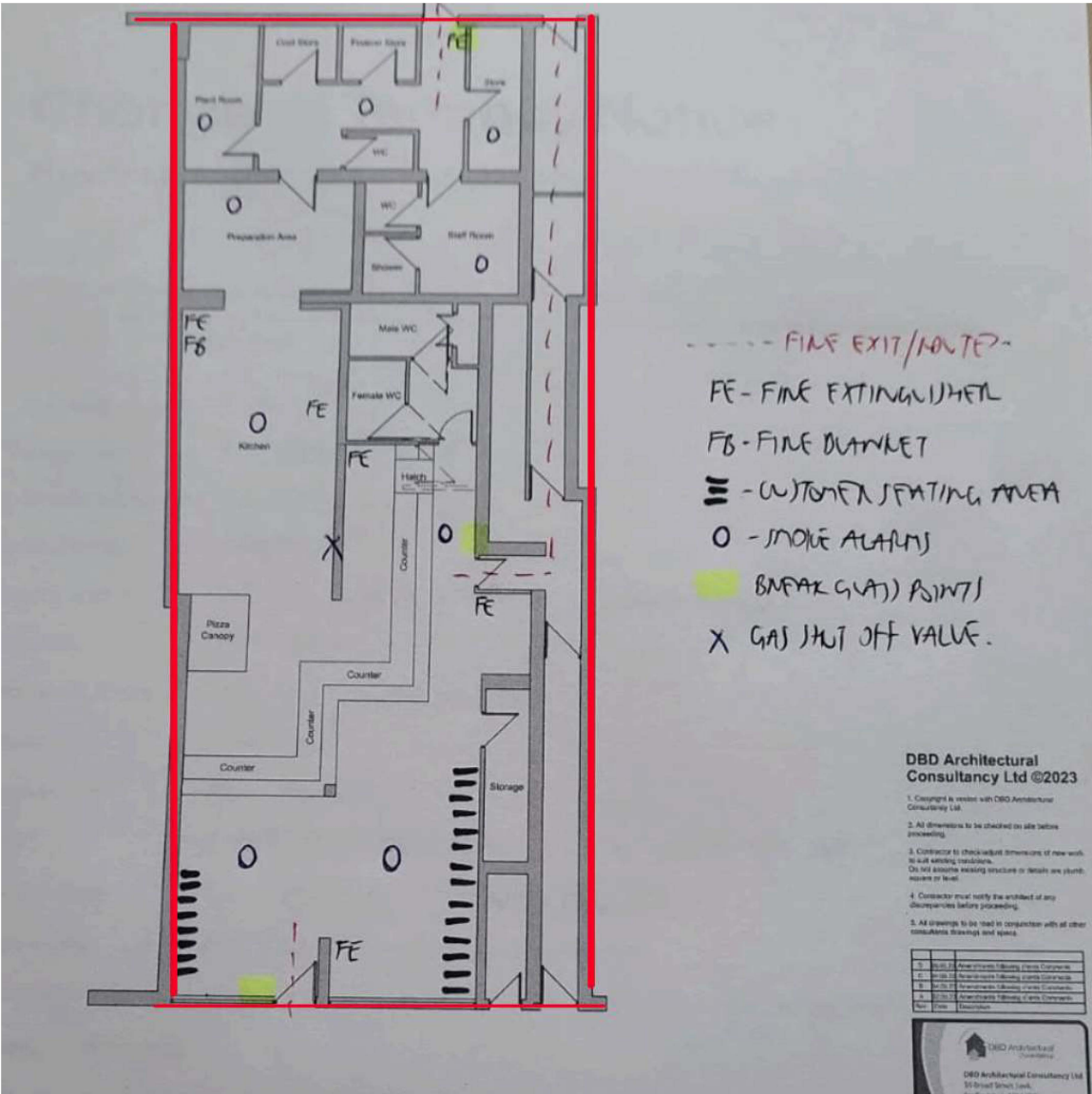

Leo Parkes

From: [REDACTED]
Sent: 03 October 2025 09:57
To: ehlicensing
Subject: RE: Tiger Bite 7-8 Mill Street

CAUTION: This email originated from outside of the Council. DO NOT click links or open attachments unless you recognise the sender and know the content is safe.

Dear Leo

Thank you, I would like to make these same representations for this new application as it has been proved right regarding the chaos that has been caused by delivery vehicles arriving and waiting to collect orders. Allowing it to be open until 3-00 am for indoors refreshments will undoubtedly cause a public nuisance to residential properties.

Many thanks
Anthony Rogers

From: ehlicensing <ehlicensing@staffordbc.gov.uk>
Sent: 01 October 2025 09:18
To: [REDACTED]
Subject: RE: Tiger Bite 7-8 Mill Street

Dear Mr Rogers

Thank you for your email.

In your representation for the previous premises licence application, you raised the following concerns:

I object to the proposed change in opening hours for Tiger Bite 7/8 Mill Street as this will cause a public nuisance to the neighbouring residential properties, also public safety due to the narrowness of Mill Street as the takeaway aspect of the business will no doubt cause many delivery vehicles arriving and waiting to collect orders. Opening to such a late time will no doubt encourage crime and disorder to an area that is a conservation area.

To clarify, are these the same representations you wish to make for this new application?

Kind regards,

Leo

From: [REDACTED]
Sent: 30 September 2025 16:36
To: ehlicensing <ehlicensing@staffordbc.gov.uk>
Subject: RE: Tiger Bite 7-8 Mill Street

CAUTION: This email originated from outside of the Council. DO NOT click links or open attachments unless you recognise the sender and know the content is safe.

Dear Sir

I object to the application for a license for Tiger Bite as it will cause a public nuisance to neighbouring properties if it stays open until 3-00 am. Opening hours were a major concern when the original application was granted and restrictions were put on the granting of the license because of this.

Your sincerely

Anthony Rogers



From: ehlicensing <ehlicensing@staffordbc.gov.uk>

Sent: 30 September 2025 12:48

To: [Redacted]

Cc: ehlicensing <ehlicensing@staffordbc.gov.uk>

Subject: RE: Tiger Bite 7-8 Mill Street

Good Afternoon

Thank you for your email. Just to clarify, this licence application is not a variation of previous licence. This application is to put a new premises licence in place for this venue.

As a resident, you are welcome to raise your concerns by raising an objection to this application, Representations may be made in writing by 17:00 on **Friday 10 October 2025**.

Please ensure that any areas of concern are related to the Licensing objectives

- Prevention of crime and disorder
- Public safety
- Prevention of public nuisance
- Protection of children from harm

Please submit any objections to this email address

Kind regards

Licensing

From: [Redacted]

Sent: 30 September 2025 12:45

To: ehlicensing <ehlicensing@staffordbc.gov.uk>

Subject: Tiger Bite 7-8 Mill Street

CAUTION: This email originated from outside of the Council. DO NOT click links or open attachments unless you recognise the sender and know the content is safe.

Dear Sir

If the application for the premises license is approved it should still have the restrictions that are applied to the current/previous license as there are still flats adjacent, opposite and nearby. Nothing has changed since the

previous application but the restrictions should be enforced along with enforcement of parking restrictions for vehicles collecting orders to be delivered.

Yours sincerely

Anthony Rogers

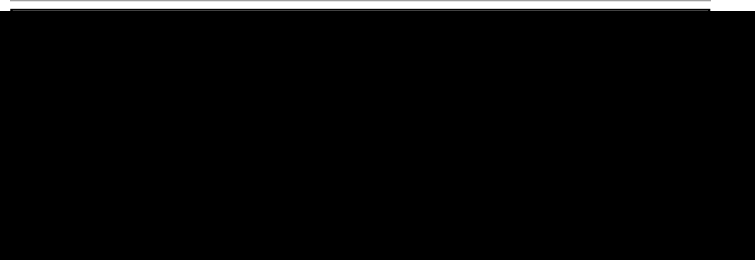

--

This message has been checked by Libraesva ESG and is found to be clean.

[Report as bad/spam](#)

[Blocklist sender](#)

--

This message has been checked by Libraesva ESG and is found to be clean.

[Report as bad/spam](#)

[Blocklist sender](#)

--

This message has been checked by Libraesva ESG and is found to be clean.

[Report as bad/spam](#)

[Blocklist sender](#)

TIGERBITG 7/8 MILL ST STAFFED 216 9AQ
 MR SOBAYA AKHTAR T/A STAFFED FASTFOOD

WOULD LIKE TO OBJECT TO THE LICENCE
 FOR THE FOLLOWING REASONS

NUISANCE AND NOISE
 I HAVE A RESIDENTIAL FLAT 20 FT FROM THE
 FRONT DOOR

THIS A CONSERVATION AREA WITH OLD PEOPLES
 FLATS AND ALMS HOUSES WITHIN A SHORT DISTANCE

SAFETY LATE NIGHT OPENING WILL ATTRACT JUVENILES
 WITH THE ENSUING PROBLEMS OF NOISE AND
 DISTURBANCES

STREET IS VERY NARROW AND AT NIGHT IS
 FREQUENTLY BLOCKED BY ILLEGALLY PARKED
 CARS AND DELIVERY VEHICLES

THIS COMPANY HAS ALREADY FLAUNTED ITS ORIGINAL
 LICENCE (OPENING LATE AND USING FRONT ACCESS)
 THEY HAVE CLEARLY SHOWN THEY ARE NOT
 SUITABLE FOR ANY EXTENSION TO IT

MR A.R PARKER





Tigerbite
Mr K Khan
7-8 Mill Street
Stafford
Staffordshire
ST16 2AJ

Date Registered	24 August 2023
Decision Date	13 December 2023
Issue Date	13 December 2023

TOWN AND COUNTRY PLANNING ACT 1990

PERMISSION FOR DEVELOPMENT

Application No:	23/37901/FUL
Proposed Development	Variation of Condition 5 (opening hours) on application 16/24544/FUL
Location	Tigerbite 7 - 8 Mill Street Stafford
O. S. Reference:	392172 323061

Stafford Borough Council, in pursuance of powers under the Town and Country Planning Act, hereby permits the above development in accordance with the accompanying plans and subject to the following conditions :

1. This permission relates to the following drawings / documents :

 Drawing No 2351/002A
 Drawing No 2351-003
 Location Plan Scale 1:1250
 Site Plan Scale 1:500
 Noise Management Plan indexed 4th October 2023
 Noise impact assessment dated 30th October 2023 (Ref: E20412)
2. The opening hours of the restaurant and takeaway shall be between the hours of 11:00am and 03:00am as stated on application forms.
3. The approved flue shall be retained in a matt black finish unless otherwise agreed in writing with the Local Planning Authority.
4. The extraction flue, odour control and noise attenuation measures detailed in Appendix A of the design and access statement and supplementary information (Annex B) as provided under 16/24544/FUL shall be maintained in accordance with the manufacturer's instructions and operated at all times when cooking is being carried out unless otherwise agreed beforehand in writing with the Local Planning Authority.
5. All deliveries to the premises shall only take place between the hours of 8:00am and 18:00pm on any day.

Tigerbite
Mr K Khan
7-8 Mill Street
Stafford
Staffordshire
ST16 2AJ

Date Registered	24 August 2023
Decision Date	13 December 2023
Issue Date	13 December 2023

TOWN AND COUNTRY PLANNING ACT 1990

PERMISSION FOR DEVELOPMENT

6. The approved noise management plan (indexed 4th October 2023) shall be implemented in full and complied with for the life of the development
7. A delivery only service shall operate from 23:00hours on any day, as per the noise management plan submitted (indexed 4th October 2023).
8. The recommended measures for noise management and mitigation as set out in the noise impact assessment dated 30th October 2023 (Ref: E20412) shall be implemented and complied with in full for the life of the development.

The reasons for the Council's decision to grant permission for the development subject to the above conditions are:

1. To define the permission.
2. To define the permission.
3. In order to safeguard the character of this part of the Stafford Conservation Area (Policy N9 of The Plan for Stafford Borough).
4. To safeguard the area from fumes, smoke and smells (Policy N1e of The Plan for Stafford Borough).
5. To safeguard the amenities of the area (Policy N1e of The Plan for Stafford Borough).
6. To safeguard the amenities of the area (Policy N1e of The Plan for Stafford Borough).
7. To safeguard the amenities of the area (Policy N1e of The Plan for Stafford Borough).

Tigerbite
Mr K Khan
7-8 Mill Street
Stafford
Staffordshire
ST16 2AJ

Date Registered	24 August 2023
Decision Date	13 December 2023
Issue Date	13 December 2023

TOWN AND COUNTRY PLANNING ACT 1990

PERMISSION FOR DEVELOPMENT

8. To safeguard the amenities of the area (Policy N1e of The Plan for Stafford Borough).

INFORMATIVE(S)

- 1 In accordance with the requirements of Article 35 of the Town and Country Planning (Development Management Procedure) (England) (Order) 2015, as amended, and the National Planning Policy Framework 2023, the Council has worked in a positive and proactive way in determining the application and has granted planning permission.



Head of Economic Development and Planning

Licensing Sub Committee Procedure

- 1 The Chairman will introduce the Members of the Sub-Committee and invite those present at each hearing to introduce themselves.
- 2 The Licensing Officer outlines the details of the application, and relevant representations received, to the Sub Committee.
- 3 Any person who has submitted a relevant representation will be given the opportunity to present details of their representation. The running order for such presentations will be decided by the Chairman prior to the first presentation commencing.
- 4 Following each submission, the Applicant or his representative may question the person concerned.
- 5 Members of the Sub-Committee may then ask questions of the person concerned.
- 6 Once all relevant representations have been heard, the Applicant or his representative presents his application for the licence and calls any witnesses in support.
- 7 Any person who has submitted relevant representations may then question the Applicant (if he has given evidence) and any witnesses.
- 8 Members of the Sub- Committee may then ask questions of the Applicant and any witnesses.
- 9 All parties who have presented relevant representations can summarise their case and comment briefly on the Applicant's replies to questions. They cannot introduce new issues.
- 10 The Applicant can summarise their case and comment briefly on the any parties replies to his questions, they cannot introduce new issues.
- 11 All parties will then withdraw whilst the Sub Committee considers the case.
- 12 The Sub Committee will deliberate in private only recalling any party to clear points of uncertainty on evidence already given. If recall is necessary all parties will return notwithstanding only one is concerned with the point giving rise to doubt.
- 13 The Chairman will announce the Sub Committee's decision and will give reasons for the decision to the parties at the end of the hearing; the decision being confirmed in writing afterwards.